

RAPTOR

INDUSTRIAL SAFETY HELMET

QUALITY • AFFORDABLE • PROTECTION

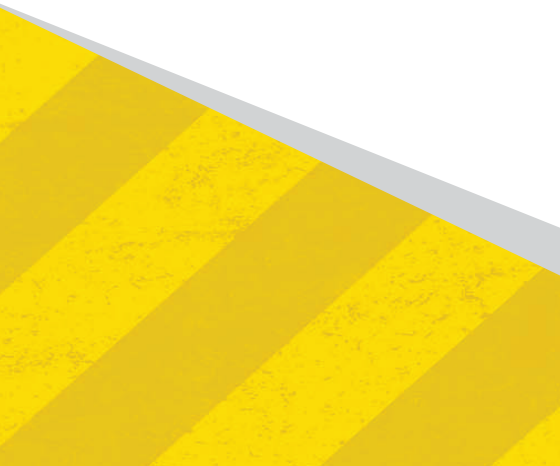

Raptor Industrial Safety Helmet

The Raptor is of a quality construction built to last and is easily fitted with standard accessories needed on the job.

Tested to EN 397:2012 - Impact and penetration protection meets AS/NZS1801 requirements.

Features:

- Impact tested to crown: 49 joules
- Chinstrap releases over 15N in accordance with EN 397
- Easy Size adjustment system
- 10 air intake vents, mesh covered to prevent debris entry
- Inner lining fully detachable and washable
- Head lamp holder clips
- 2 slots for mounting ear defenders & visors

Available Accessories

Ear Protection



Face and Head Protection



Visor



Head Lamp



For more information on helmet accessories please visit:

www.staysafesystems.co.nz

Donning Instructions:

1. Before donning, rotate the adjustment dial on the back of the cradle anti-clockwise until the cradle is in its widest position.
2. Put on the helmet and adjust the dial (clockwise to tighten, anticlockwise to loosen) until you obtain the desired fit.
3. Position the back of the cradle in the nape of the neck, tilting it as required.
4. Fasten the chin strap by inserting one side of the buckle into the other, until you hear the locking mechanism click shut. Tug strap to ensure that the buckle is securely fastened.

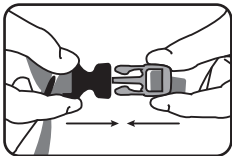
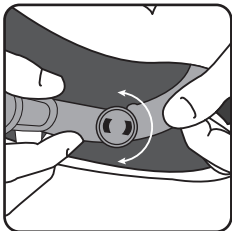
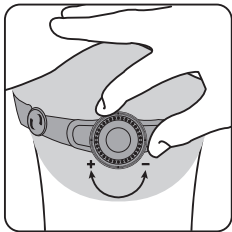

Fig. 2

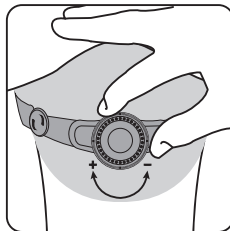

Fig. 4

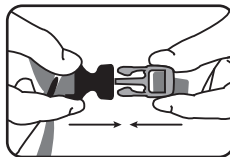

Fig. 6

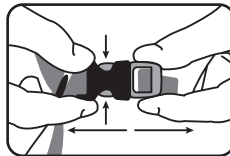

Fig. 3

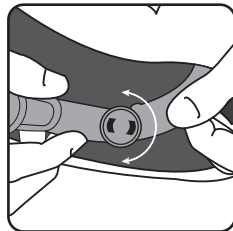

Fig. 5

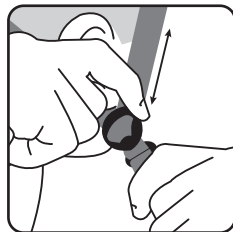
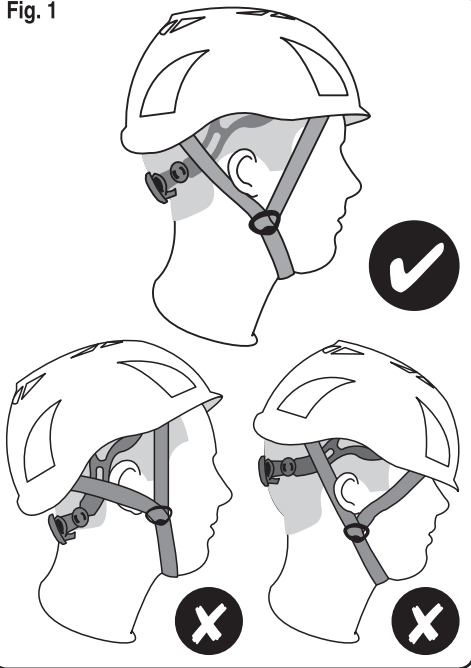
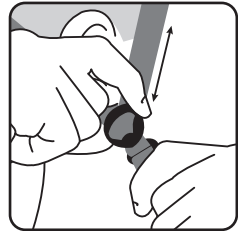

Fig. 1



5. Adjust the length of the neck strap to fit the helmet securely to your head. Slide the strap loop to hold loose strap in place.



6. To position the chin strap correctly, adjust the chin strap positioners forward or back until they sit directly under your ears.

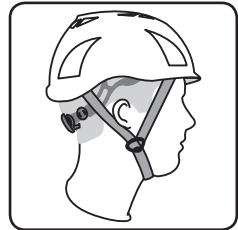

7. After properly buckling and adjusting the strap, check that the helmet is not excessively tight, does not move freely back and forth or side to side, and is well seated and centered on the head.

8. To remove the helmet, release the chin strap by squeezing together the tips of the male side of the snap buckle.

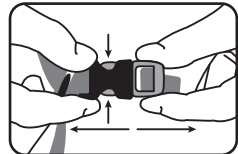

GUARANTEE

This product is guaranteed for 2 years against any defects in materials or manufacturing. Exclusions from the guarantee: normal wear and tear, oxidation, modifications or alterations, incorrect storage, poor maintenance, damage due to accidents and/or negligence, or to improper and incorrect usage. Stay Safe Systems Goleman Limited is not responsible for the consequences, direct, indirect or accidental, or any other type of damage befalling or resulting from the use of its products.

LABELING

Information contained on the inside of the helmet, printed on a label, should not be removed for any reason.

DANGER!

This helmet is intended use in activities that are extremely dangerous.

FAILURE TO HEED AND FOLLOW THESE INSTRUCTIONS AND ANY OF THESE WARNINGS MAY RESULT IN SERIOUS INJURY OR EVEN DEATH.

This helmet has no electrical insulation rating.

DO NOT USE THIS HELMET IN AN ELECTRICAL HAZARDOUS ENVIRONMENT.

WARNING

Carefully read and understand these instructions. Use this helmet exclusively for the activities for which it is certified and in strict accordance with all applicable OSH regulations.

Improper use of this helmet can cause serious or fatal injury. If the instructions are not followed correctly, the level of protection offered by the helmet can be significantly reduced. Inspect the helmet before every use for any signs of visible damage.

DO NOT USE HELMET AFTER IT HAS SUSTAINED A MAJOR IMPACT OR IF YOU ARE UNSURE OF ITS CONDITION.

The user must familiarise themselves with all features, capabilities and limitations of the helmet, and receive specific instructions and/or training from a competent and responsible person in the proper use of the helmet.

USERS OF THE HELMET ARE FULLY RESPONSIBLE FOR THEIR ACTIONS AND ASSUME ALL RISKS FOR THEIR DECISIONS.

Stay Safe Systems Goleman Limited, its affiliates, subsidiaries, importers, distributors and dealers will accept no responsibility in the event of an accident leading to injury or death and shall not be liable for any injury, death, loss, or damage resulting from improper use of this helmet.

WARNING

Activities involving the use of this equipment are inherently dangerous. You are responsible for your own actions and decisions.

Before using this equipment, you must:

- read and understand all instructions for use;
- get specific training in its proper use;
- become acquainted with its capabilities and limitations;
- understand and accept the risks involved.

Failure to heed any of these warnings may result in severe injury or death. The manufacturer and/or distributor will accept no responsibility in the event of accidents leading to injury or death due to improper use of the helmet.

This helmet is designed to absorb impact by partially distributing the shock or by damaging its essential components. Activities at height and in industrial situations present a risk of serious head injury. Wearing a helmet can significantly reduce this risk, but cannot entirely eliminate it. This helmet should be used exclusively for the activities for which it is certified (see Labeling). This helmet has been approved for industrial head protection and mountaineering.

CAUTIONS BEFORE USE

WARNING - SPECIFIC TRAINING IS ESSENTIAL BEFORE USE.

Read this notice carefully and keep all instructions and information on the proper use and application of the product(s). Many types of misuse exist and it is impossible to specify all of them. Contact Stay Safe Systems Goleman Limited if you have any doubt or difficulty understanding these instructions.

Activities at height are dangerous and may lead to severe injury or

death. Gaining adequate training in appropriate techniques and the results of inspections should be documented in an "inspection record". This document must allow recording of the following details:

- type of equipment;
- model and ID number (eg. serial number);
- name and contact details of manufacturer or distributor;
- year of manufacture, date of purchase, and date of first use;
- name of user;
- all other pertinent information such as maintenance history and frequency of use;
- a history of periodic inspections (including date, comments and noted problems, plus the name and signature of the competent person who performed the inspection).

When to Retire Your Equipment:

Immediately retire any equipment if:

- it fails to pass inspection (including inspection before and during use and the periodic in-depth inspection);
- it has been subjected to a major fall or load;
- you do not know its full usage history;
- it is more than 5 years old;
- you have any doubt as to its structural integrity. Destroy retired equipment to prevent further use.

Product Obsolescence:

There are many reasons why a product may be judged obsolete and thus retired before the end of its actual lifetime. For example: changes in applicable standards, regulations, or legislation; development of new techniques; incompatibility with other equipment; etc.

PRODUCT LIFE AND INSPECTION GUIDELINES

Product Life:

The actual lifetime of a product ends when it meets one of the retirement criteria listed below (see “When to retire your equipment”), or when it is judged obsolete (see “Product Obsolescence”). The actual lifetime is influenced by a variety of factors such as the intensity, frequency, and environment of use, the competence of the user, how well the product is stored and maintained, etc.

ATTENTION: in extreme cases, the lifetime of the product can be reduced to one single use through exposure to, for example, any of the following: chemicals, extreme temperatures, sharp edges, major fall or load, etc. Inspect the helmet regularly to check for any damage! Cracks, detached parts, warping, flaking, and changes in colour are significant a sign of the helmet’s state of deterioration; Regardless of apparent condition, we advise replacing the helmet after 5 years, because its ability to protect decreases over time due to the aging of the materials. The manufacturing date is shown on the inside of the helmet.

Product Inspection:

Inspect equipment periodically for damage and/or deterioration. If you find any minor cuts, abrasions, or other visible damage, make sure the helmet is subject to a detailed inspection before further use. In addition to the inspection before and during use, a periodic in-depth inspection must be carried out by a competent inspector at least once every 12 months. The frequency of the in-depth inspection must be governed by the type and the intensity of use. To keep better track of your equipment, it is preferable to assign each piece of equipment to a unique user so that he/she will know its history.

Methods of protection are the user’s responsibility. The user personally assumes all risks and responsibilities for all damage, injury or death

which may occur during or following incorrect use of our products in any manner whatsoever. If the user is unable to assume this responsibility and risk, they must not use this equipment.

This product must only be used by competent and responsible persons, or those placed under the direct and visual supervision of a competent and responsible person. Personal protective equipment (PPE) is to be used only on or with energy absorbing systems (for example dynamic ropes, energy absorbers etc.). Refer to the instructions specific to the other components of your equipment to check that this product is compatible with them. To prolong the life of this product, take care when transporting and using it. Avoid impacts, or contact with abrasive surfaces or sharp edges.

WARNING: This helmet cannot always protect the user from injury. Specifically, the user must be aware that no helmet can protect the head from the shock generated by violent impact. **Following violent impact, even if no damage is visible, the helmet should be replaced**, as its capacity to absorb further impact could be impaired.

Certain chemical products, especially solvents, can damage your helmet. **Protect your helmet from exposure to chemicals.**

Paint and stickers may contain materials that, with time, can alter the physical properties of the helmet. Before applying any of these products, verify their compatibility with the helmet materials.

Your helmet can be damaged from improper care: do not sit on it, pack it too tightly, drop it, allow it to contact sharp or pointed objects, etc. Do not expose your helmet to high temperatures, such as inside a vehicle in direct sunlight.

INSTRUCTIONS FOR USE

This helmet must be worn at all times during work activity. For adequate protection, it is important that the helmet be sized correctly and fit the head properly to offer optimum comfort and safety.

The helmet should be adjusted to fit the user; for example, the straps should be positioned so that they do not cover the ears, the buckle should be kept away from the jawbone, and the straps and buckle should be adjusted so that they are comfortable and secure.

After properly buckling and adjusting the strap, always check that the helmet is not excessively tight, does not move freely back and forth or side to side, and is well seated and centered on the head (see Fig. 1). The less the helmet can move, the better protection it will provide.

Before donning, rotate the adjustment dial on the back of the cradle anticlockwise until the cradle is in its widest position.

Put on the helmet and adjust the dial (clockwise to tighten, anti-clockwise to loosen) until you obtain the desired fit (Fig. 2).

Position the back of the cradle in the nape of the neck, tilting it as required (Fig. 3).

Fasten the chin strap by inserting one side of the buckle into the other, until you hear the locking mechanism click shut (Fig. 4). Tug strap to ensure that the buckle is securely fastened.

Adjust the length of the neck strap to fit the helmet securely to your head. Slide the strap loop to hold loose strap in place.

To position the chin strap correctly, adjust the chin strap positioners forward or back until they sit directly under your ears (Fig. 5).

To remove the helmet, release the chin strap by squeezing together the lips of the male side of the snap buckle (Fig. 6).

Cleaning and Storage Instructions:

CLEANING: Clean the helmet only with water, neutral pH soap, and a soft, clean cloth, allowing it to air dry at room temperature. The removable cradle lining can be hand- or machine-washed in cold water (max. 30°C - 85°F). In no case should chemical detergents or solvents be used.

STORAGE: When not in use, the helmet should be stored away from direct sunlight and sources of heat. We recommend storing it in the original packaging. Do not drop the helmet after wearing, as repeated small impacts can reduce the integrity and life of the helmet.

TRANSPORT: During transport do not pack the helmet too tightly.

Modifications, Parts and Accessories:

REPLACEMENT PARTS: If necessary, contact the dealer or contact the manufacturer directly. None of the original components of the helmet may be changed and/or removed without the manufacturer's approval. The helmet should not be modified to attach any unapproved accessories.

ACCESSORIES: Check with the dealer or manufacturer what accessories are available. If they are supplied with the helmet, follow the mounting instructions that come with the accessory. Only accessories approved by the manufacturer should be used.

MODIFICATIONS AND REPAIRS: Do not apply adhesives, solvents, stickers or paint that does not comply with the manufacturer's specifications. Do not modify the helmet in any way unless the modifications are specifically authorized by Stay Safe Systems Goleman Limited. An unauthorized modification can reduce the product's effectiveness and invalidate its certification. Repairs made outside of Stay Safe Systems Goleman Limited facilities are prohibited.

**MANUFACTURED FOR STAY SAFE SYSTEMS
0508 STAY SAFE**

For all your height safety requirements visit:

www.staysafesystems.co.nz

8 Malvern Road, Ngauranga, Wellington, NZ

PO Box 12690, Thorndon, Wellington 6035

T. (04) 472 3929

E. sales@staysafesystems.co.nz

