



DEVON COTTAGE

Assembly & Operation Instructions

Heavy Duty 55mtr Cranked Four Arm Rotary Clothesline

Assembly

1. Carefully remove all packaging
2. Establish a suitable location for the rotary. Please ensure there is enough room for it to rotate freely when fully open (2.8 Metres diameter)
3. Install your ground socket (c). The ground socket supplied is for installation into a concrete mix. It is recommended that you follow the below steps
 - a. Dig a hole at least 20cm square and 50cm deep
 - b. Partly fill the hole with gravel and place the spike upright in the centre
 - c. Complete filling with concrete and ensure when installing that the socket is firmly located and in a vertical position
 - d. Allow 48 hours for setting before use
4. Insert lower section (b) into upper section (a). This is fully inserted when the top of the lower section marries up to the shaped collar on the upper section centre pole.
5. Insert the clothesline into the ground socket

Operation

Crank the handle to raise and lower your rotary

Storage

When not in use, we recommend that the clothesline is covered and securely fixed.

If removing from the socket for storage, please ensure that the clothesline is covered and kept out of the reach of children.

Parts Included

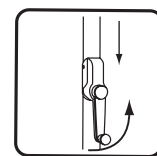
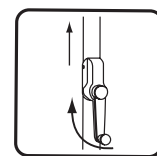
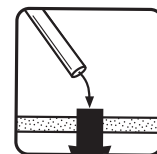
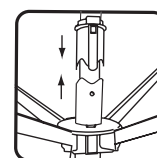
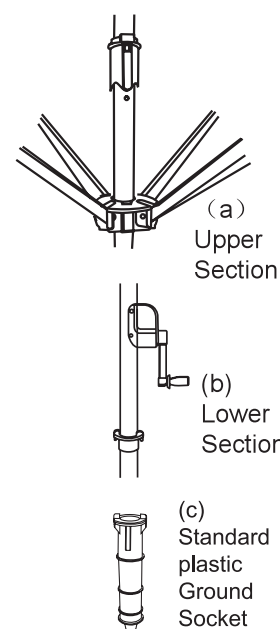

Turning Circle

