

1 Mark door

Mark the centres for installing the mortice latch with the installation template supplied. Make sure you use the correct backset 2 3/8" (60mm), 2 3/4" (70mm). The backset is the distance between door hole centre and the door edge.

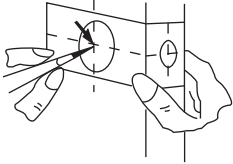

2 Bore two holes

With the determined points as centres, bore a 2 1/8" (54mm) hole in the door face, then a 15/16" (24mm) hole in the door edge. Cut out the edge of the door using a chisel so that the latch face can be flush into the door edge. Install latch and make sure latch bevel is correct for the hand (closing) of the door. Secure latch with two screws provided.

**Special note: Ensure the latch face is not set below the level of the door edge, if it is, pack up the back of the latch to ensure a flush fit.*

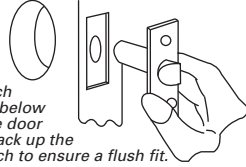

3 Strike positioning

Close door until latch touches jamb to locate striker plate in jamb and centre-line of strike. Open door and extend line from mark to door stop. Measure one half of door thickness from door stop and vertically mark drill point centre for striker plate. Drill 15/16" (24mm) latch hole in the frame 9/16" (15mm) deep. Chisel 1/16" (1.5mm) deep for the strike matching the 15/16" (24mm) hole in door.

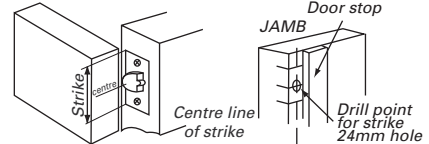

4 Install strike

When installing the strike plate, be sure it is set to the same height as the latch. The latch bolt should fit into the strike case, the small guard bolt (if present) should not go into the strike. Install the two screws provided. The adjustable tang permits bending in or out to eliminate excessive looseness between door and stop. Ensure the latch is in the at rest position (i.e Fully extended when the door is closed).

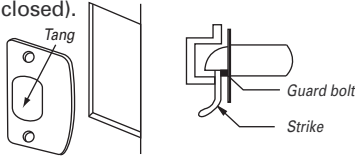

5 Remove inside handle

To pull off the inside lever, use the tip of the tool supplied to press down the retainer located inside the small hole. The hole is located on the neck of the inside lever.

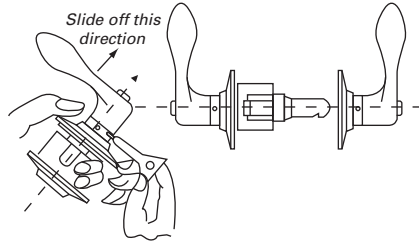

6 Adjust to required door thickness

Adjust the lock to fit the door by turning the outside back plate to the door thickness.

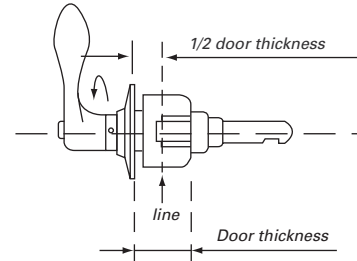

7 Install outside handle

Install lever handle from outside face of the door and be sure chassis engages with latch prongs and retractor interlocks with latch bar. There must be no resistance when engaging lever handle onto latch. If binding occurs the main hole housing the lever handle may need further machining out towards the hinge side of the door. This can be done using a rotary drum rasp.

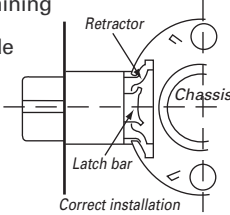

8 Install interior rose

Place the inside fixing plate onto the lock body and tighten with the two machine screws provided. Screw interior rose over fixing plate. For final tightening use "C" spanner tool provided by engaging in hole of rose and tightening against door.

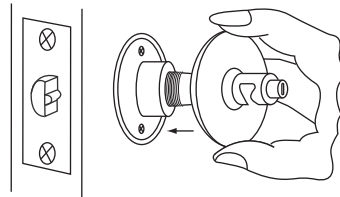

9 Install inside lever

Align internal lug of lever with narrow slot on side of chassis and push lever all the way in until retainer clicks into lug of lever.

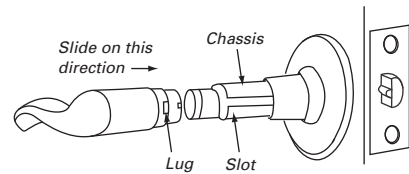

10 Check for correct installation

Ensure the lever handle sits parallel in the door open and the closed positions. If door is open and fitted lever handle is sitting parallel, but when door is closed handle droops the following needs to be done:

- (Re look at the point four). Ensure there is adequate clearance behind the striker plate to enable the latch mechanism to fully extend into it's at rest position when door is closed. (i.e. further chiselling out of the hole is required).
- Ensure that the adjustable tongue on striker plate enables latchbolt to fully extend into its rest position when door is closed.
- When the door is open or closed the lever handle is not sitting parallel or droops.
- Check the drilling of the backset, the latch when fitted should not protrude into the 54mm or 57mm hole other than the small engaging mechanism. Adjustment may be needed by opening up the 54mm hole to ensure the lever handle sits in the correct position.
- For quick adjustment of the 54mm hole a rotary drum rasp (30mm approx) can be purchased from most hardware stores and fitted onto a cordless/power drill.
- The rasp can be used to elongate the 54mm hole towards the hinge side of the door (usually) so that the latch mechanism slides more freely into retractor assembly without compressing the mechanism.

Residential Door Hardware Warranty

Sylvan residential door hardware products are covered by the following warranty.

- 10 year mechanical.
- 5 year finish (see exclusions below).

Subject to the following conditions:

If a finish or mechanical defect occurs within the warranty period, simply return the product together with proof of purchase to the point of purchase. Upon receipt of defective product it will be either repaired or replaced free of charge. This warranty only applies to the original user of the product, and is non transferable.

The Sylvan residential door hardware warranty excludes the following:

Indirect or consequential loss or damage • Cost of removal and or replacement • Cost of freight and or travel time • Improper installation or failure to follow fitting instructions • Abuse or misuse of the product • Use of the product for the purpose which the product was not designed • Scratches from keys/rings, abrasions or deterioration due to use of paint, solvents or other chemicals • Use of the product in exposed coastal or geothermal conditions • The plated finishes of Polish Brass and Black Nickel are classified as soft finishes. As deterioration is possible under some climatic conditions, these finishes are excluded from this warranty.

Applicable door thickness
from 29mm to 45mm

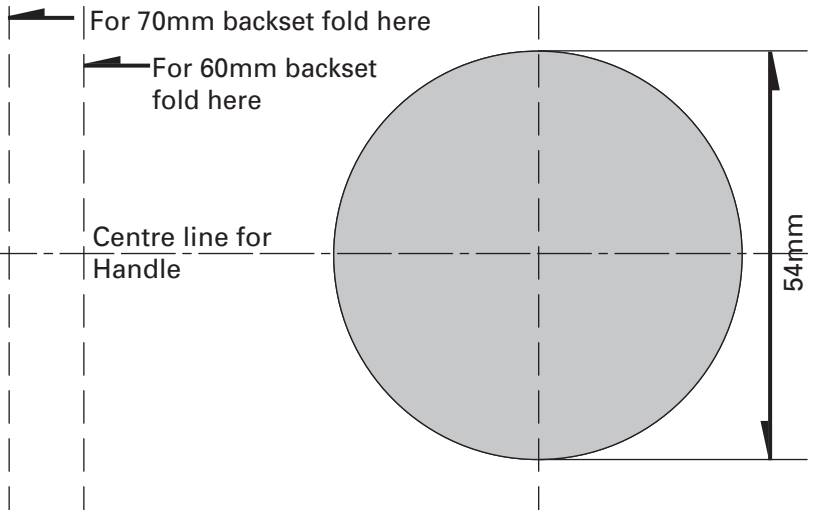
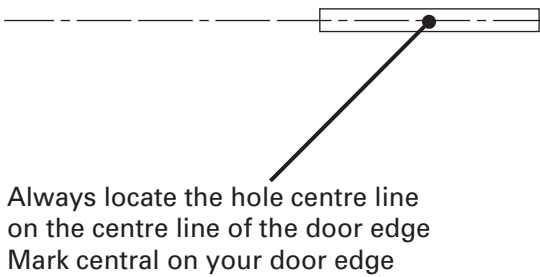

*PLEASE NOTE: If re-printing this template,
ensure you print 1:1 ratio, and double check
the drilling template with an accurate ruler*

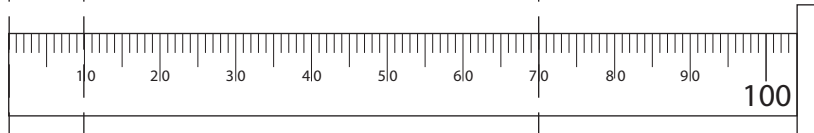

Installation Template

GDRutter
Limited

P: +64 9 444 5359 F: +64 9 444 3972 sales@gdrutter.co.nz www.sylvan.co.nz

SYLE30/E10000003