

SHOE RACK
Assembly Instructions

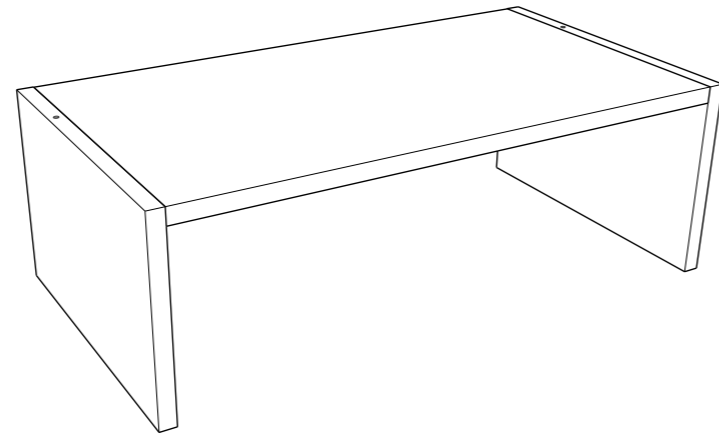

Art. 730.83.227

Wardrobe Panels included.

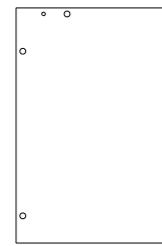

END PANEL (x2)

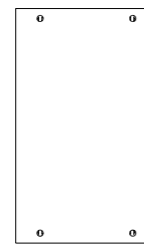

TOP PANEL (x1)

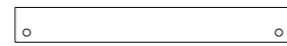

RAIL (x1)

HÄFELE Hardware included.

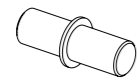

LOCATING PINS (2)



CAMS (6)

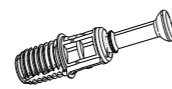

CAM DOWELS (6)



DOWELS (2)

Required Tools.



SCREWDRIVER

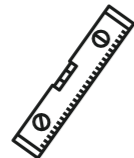

LEVEL

Handy Note: Please read the instructions carefully before you start and make sure to identify the parts you need for each step. When assembling it is best to do on a soft surface to prevent damage. **Your Connex 15 Year Home Use Warranty will not apply to incorrectly assembled and/or installed product. Follow the advice of your selected wall fixings (sold separately) to ensure suspension rail can support loaded wardrobes.**

Manufactured in New Zealand for: Mitre 10 New Zealand Limited.



1. Fitting the Cam Dowels and Dowels into the End Panels.

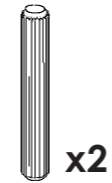

x2



x6

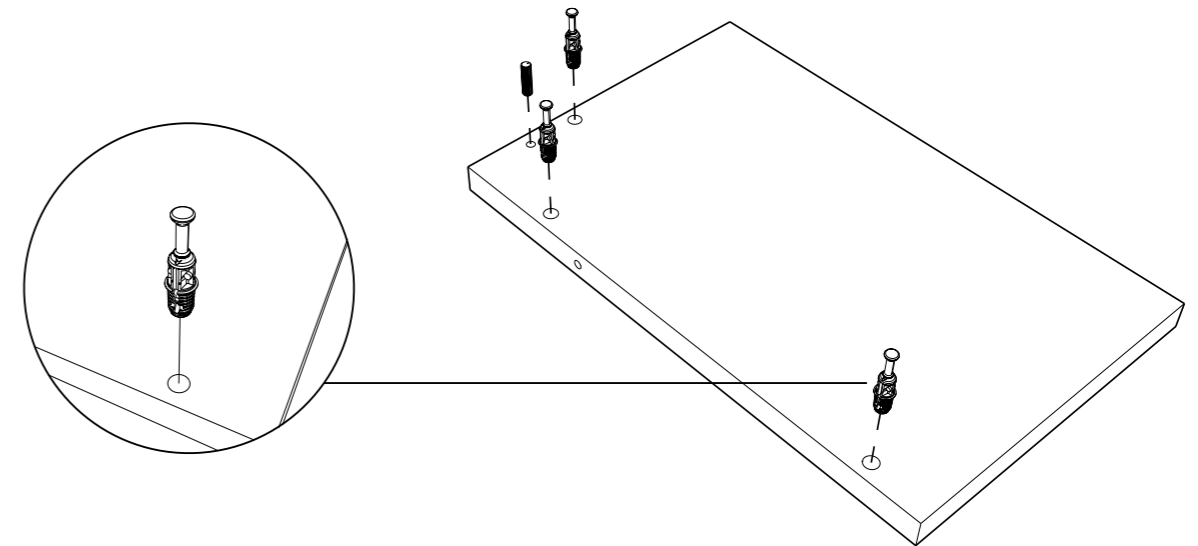

* Repeat for second end panel.

2. Inserting the Cams into Top and Rail Panels.



x6

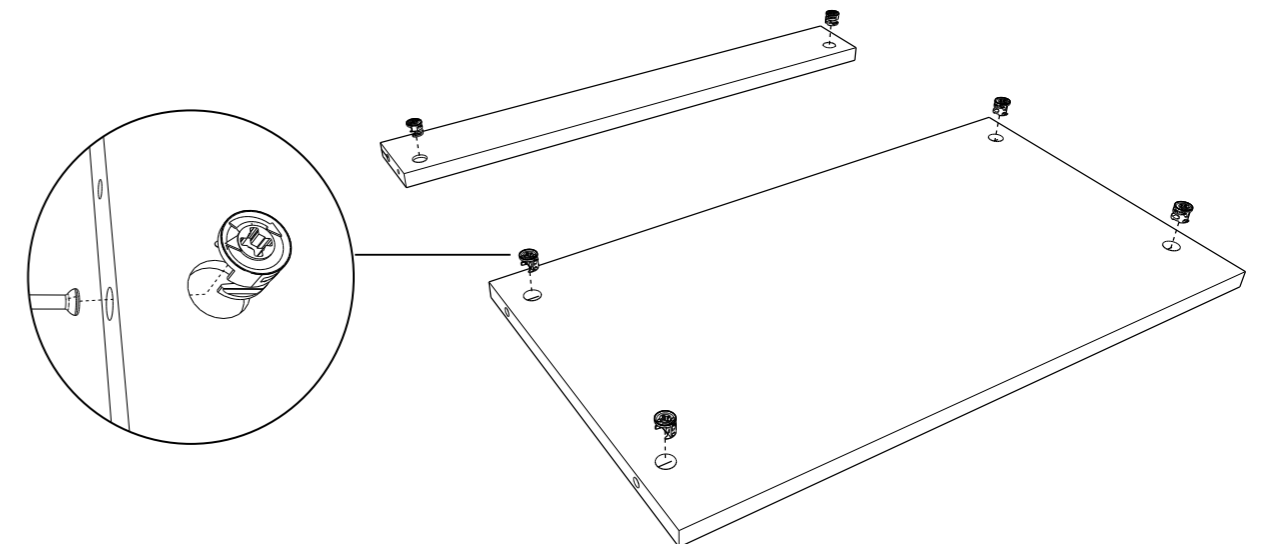

3. Fixing the End Panels to Top and Rail Panels.

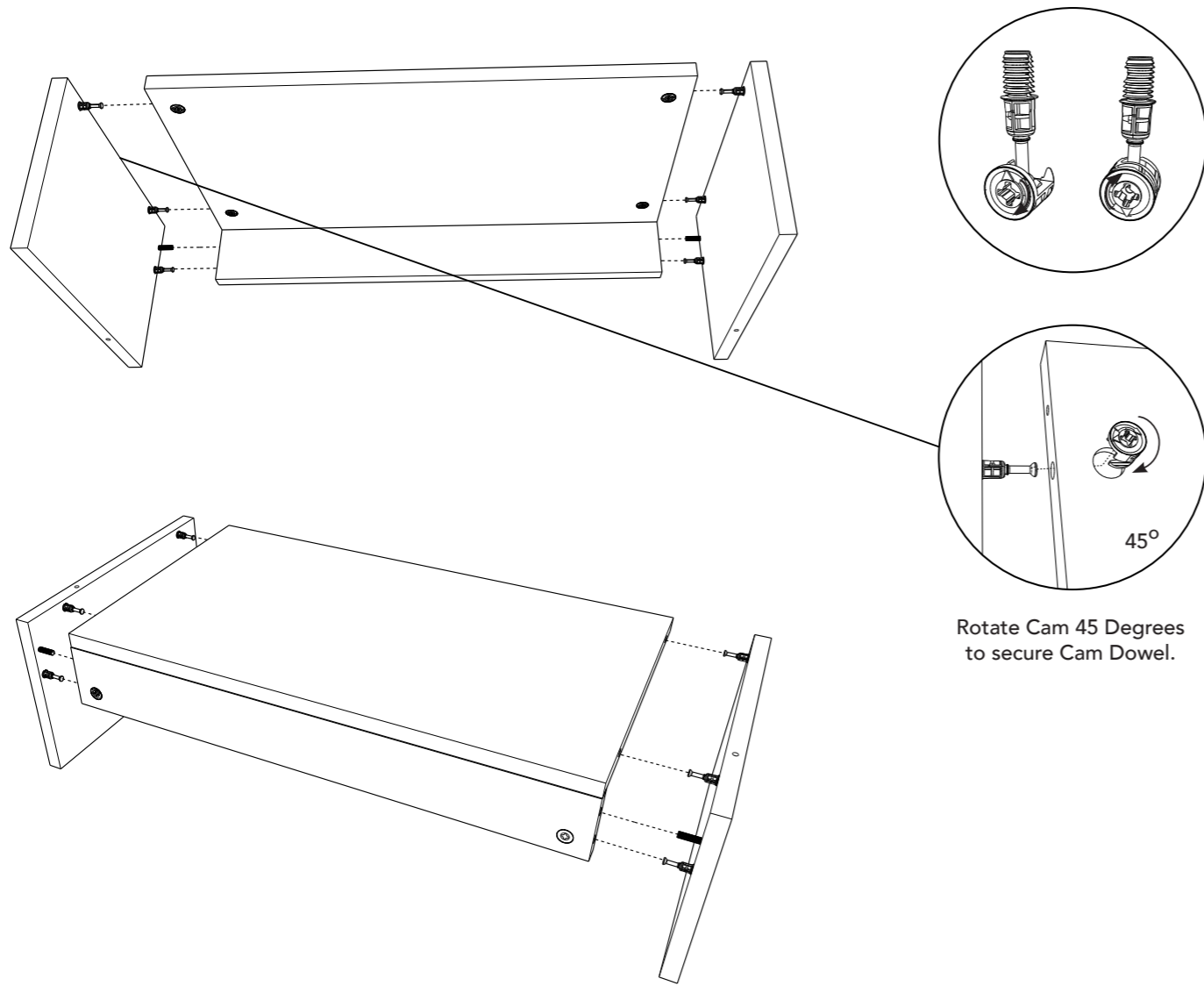

Rotate Cam 45 Degrees to secure Cam Dowel.

4. Stacking multiple Shoe Racks.

* second shoe rack sold separatley

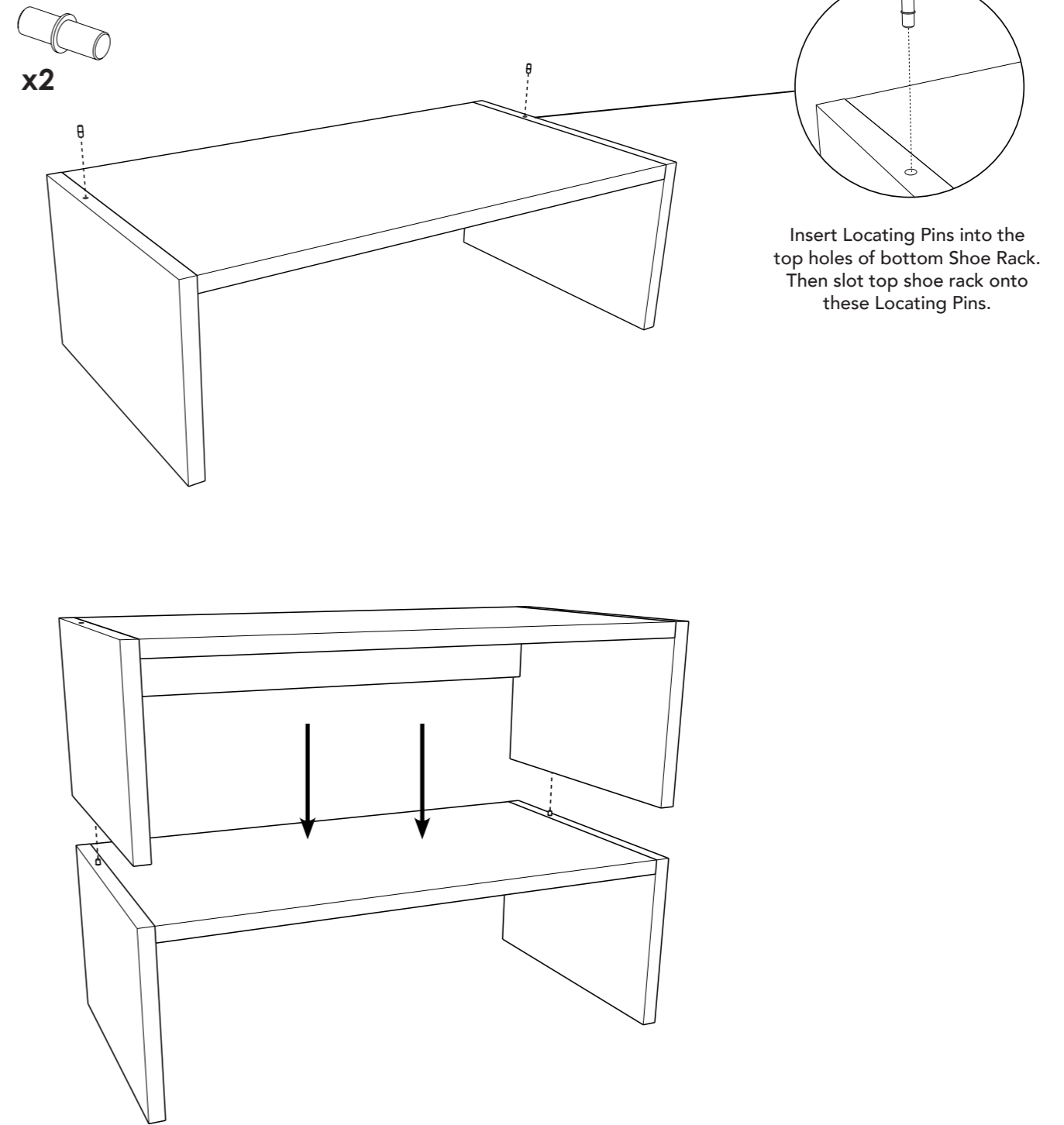

Insert Locating Pins into the top holes of bottom Shoe Rack. Then slot top shoe rack onto these Locating Pins.